

---

<b>Report To:</b>	<b>Environment &amp; Regeneration Committee</b>	<b>Date: 30 August 2018</b>
<b>Report By:</b>	<b>Corporate Director Environment, Regeneration &amp; Resources</b>	<b>Report No: ERC/ENV/MM/17.342</b>
<b>Contact Officer:</b>	<b>Martin McNab</b>	<b>Contact No: 01475 717171</b>
<b>Subject:</b>	<b>Proposed Traffic Regulation Order – The Inverclyde Council (Various Roads) (Gourock, Inverkip &amp; Wemyss Bay) (Waiting Restrictions) (Variation No. 4) Order 2018</b>	

---

## 1.0 PURPOSE

- 1.1 Local Authorities are empowered to make Orders under the Road Traffic Regulation Act 1984 as amended and under the Council's Scheme of Administration the Head of Environmental & Public Protection is responsible for the making, implementation and review of Traffic Management Orders and Traffic Regulation Orders.
- 1.2 The purpose of the report is to introduce the proposed modified Traffic Regulation Order (TRO) – The Inverclyde Council (Various Roads) (Gourock, Inverkip & Wemyss Bay) (Waiting Restrictions) (Variation No.4) Order 2018.
- 1.3 The attached modified TRO is proposed which removes the proposed restrictions on Cloch Road.

## 2.0 SUMMARY

- 2.1 The proposed Traffic Regulation Order will:-
  - Introduce a “No waiting at any time, no loading at any time” restriction on parts of Burnside Road, Drumshantie Road, Kirn Drive and Reservoir Road, all in Gourock;
  - Introduce a “No waiting at any time” restriction on parts of Barrhill Road, Binnie Street, Broomberry Drive, Cardwell Road, Drumshantie Road, Faulds Park Road, George Road and Tarbet Street, all in Gourock;
  - Vary the existing “No waiting at any time” restriction to a “No waiting at any time and No loading at any time” restriction on part of Kirn Drive, Gourock;
  - Vary the existing “No waiting Monday to Saturday 8am to 11am” and “Limited Waiting Monday to Saturday 11am to 6pm, 1 hour, No return within 1 hour” restrictions to create a “Loading Bay Monday to Saturday 8am to 11am” and “Limited Waiting Monday to Saturday 11am to 6pm, 1 hour, No return within 1 hour” restriction on Kempock Street, Gourock (outside 2-8 Kempock Street); and
  - Revoke part of the “No waiting at any time” restriction on Victoria Road, Gourock.

### 3.0 **RECOMMENDATION**

- 3.1 That the Committee recommend to The Inverclyde Council the making of the modified Traffic Regulation Order – The Inverclyde Council (Various Roads) (Gourock, Inverkip & Wemyss Bay) (Waiting Restrictions) (Variation No.4) Order 2018 and remit it to the Head of Environmental & Public Protection and the Head of Legal & Property Services to arrange for its implementation.

**Martin McNab**  
**Environmental and Public Protection**

## 4.0 BACKGROUND

- 4.1 The Inverclyde Council introduced Decriminalised Parking Enforcement throughout Inverclyde in 2014. Since that time numerous requests have been received to introduce waiting and loading restrictions at various locations in Gourrock. This TRO promotes various restrictions to address these requests.
- 4.2 During the promotion of this TRO two objections were received and maintained. The objections require to be regarded as withdrawn because the proposed restrictions for Cloch Road, Gourrock have now been removed from this proposed TRO. The objectors have been informed of the position.
- 4.3 This TRO was due to be the subject of a Special Meeting of this Committee on 17 September 2018. However, in preparation for the Special Meeting officers compiled the relevant documents and noted an inconsistency as between the TRO documents (including the Council's Statement of Reasons) and the maps in relation to the proposed restrictions on Cloch Road, Gourrock. This means that the proposed restrictions for Cloch Road could not have been lawfully made.
- 4.4 To address this, the attached modified TRO is proposed which removes the proposed restrictions on Cloch Road. It retains all of the other proposed restrictions advertised and listed in Paragraph 2.1, above.
- 4.5 The Committee is asked to note that, if approved, the modified Order may not be implemented until the making of the Order has been advertised to allow any persons who so wish a period of six weeks to question the validity of the Order in terms of the Road Traffic Regulation Act 1984.

## 5.0 IMPLICATIONS

### Finance

- 5.1 There will be a cost for introducing the signs and road markings for the new restrictions. These will be contained within the Parking Strategy Revenue budget.

#### One off Costs

<b>Cost Centre</b>	<b>Budget Heading</b>	<b>Budget Years</b>	<b>Proposed Spend this Report</b>	<b>Virement From</b>	<b>Other Comments</b>
02506	Parking Strategy Revenue	18/19	£8,000		New signs and lines

### Legal

- 5.2 Legal Services have been consulted in the preparation of this report.

### Human Resources

- 5.3 There are no HR implications arising from this report.

### Equalities

- 5.4 There are no equalities implications arising from this report.

### Repopulation

- 5.5 There are no repopulation implications arising from this report.

## **6.0 CONSULTATIONS**

- 6.1 The proposals have been advertised in the Greenock Telegraph and full details of the proposals have been made available for public inspection during normal office hours at the offices of the Head of Environmental & Commercial Services, the Head of Legal & Property Services and at Central and Gourock Libraries. A copy of the draft Order is appended hereto for Members' information. Appendix 1

## **7.0 LIST OF BACKGROUND PAPERS**

- 7.1 None

**THE INVERCLYDE COUNCIL**  
**(VARIOUS ROADS) (GOUROCK, INVERKIP &**  
**WEMYSS BAY) (WAITING RESTRICTIONS)**  
**(VARIATION NO. 4) ORDER 2018**

**TRAFFIC REGULATION ORDER**

**THE INVERCLYDE COUNCIL  
(VARIOUS ROADS) (GOUROCK, INVERKIP & WEMYSS BAY)  
(WAITING RESTRICTIONS) (VARIATION NO. 4) ORDER 2018**

We, The Inverclyde Council in exercise of the powers conferred on us by Sections 1(1), 2(1) to (3), 4(2), 32(1), 35(1), 45, 46, 49, 53, 101 and 102 of the Road Traffic Regulation Act 1984 (as amended) (“the Act”) and of Part IV of Schedule 9 to the Act and of all other enabling powers and after consulting the Chief Constable of the Police Service of Scotland (Seirbheis Phoilis na h-Alba) in accordance with Part III of Schedule 9 to the Act hereby make the following Order:

**1.0 Commencement and citation**

1.1 This Order shall come into operation on the \*\* day of \*\*, Two Thousand and \*\* and may be cited as “The Inverclyde Council (Various Roads) (Gourock, Inverkip & Wemyss Bay) (Waiting Restrictions) (Variation No. 4) Order 2018”.

**2.0 Interpretation**

2.1 In this Order, except where the context otherwise requires, the following expression has the meaning hereby respectively assigned to it:

“No Return” in relation to a Limited Waiting Parking Place, where waiting is limited by time and day of the week, means no return within the stated time and day of the week to a Limited Waiting Parking Place in the same road as the Limited Waiting Parking Place vacated.

2.2 Except where otherwise stated, any reference in this Order to a numbered Article or Schedule is a reference to the Article or Schedule bearing that number in this Order.

2.3 Any reference in this Order to any enactment shall be construed as a reference to that enactment as amended, modified, re-enacted, replaced or supplemented by any subsequent enactment.

2.4 The prohibitions and restrictions imposed by this Order shall be in addition to and not in derogation from any restriction or requirement imposed by any regulation made or having effect as if made under the Act or by or under any other enactment provided that where a prohibition or restriction which is imposed, varied or revoked by this Order is in conflict with a prohibition or restriction imposed by a previous Order, then the provision of this Order shall prevail.

2.5 The On-Street Plans forming Schedule 1 to this Order and titled “The Inverclyde Council (Various Roads) (Gourock, Inverkip & Wemyss Bay) (Waiting Restrictions) (Variation No. 4) Order 2018 On-Street Plans” are hereby incorporated into “The Inverclyde Council (Various Roads) (Gourock, Inverkip & Wemyss Bay) (Waiting Restrictions) Order 2013” (“the Principal Order”) and recorded in “Plan Index” to the Principal Order”.

- 2.6 The Plan Index forms Schedule 2.
- 2.7 The Interpretation Act 1978 (as amended) shall apply for the interpretation of this Order as it applies for the interpretation of an Act of Parliament.
- 3.0 **Revocation and substitution of Article contained within existing Traffic Regulation Order**

Article 5.1 of the Principal Order is hereby revoked and the following Article (which is incorporated into the Principal Order) substituted therefor:-

5.1 Where, in relation to any part of a Road shown on the On-Street Plans, a period of 'limited waiting' is indicated then, subject to the provisions of Article 5.2, no person shall, except upon the direction of a police constable in uniform, a Parking Attendant or an Authorised Person, cause or permit any Motor Vehicle to wait during that period in that part of the Road:

- (a) for longer than the maximum period of waiting specified for that part of the Road; or
- (b) if a period of less than the No Return interval specified for that part of the Road has elapsed since the termination of the last period of waiting of the Motor Vehicle in that part of the Road.

*This Order and the two Schedules annexed hereto are sealed with the Common Seal of The Inverclyde Council and subscribed for them and on their behalf by ##.*

**SCHEDULE 1**

**The Inverclyde Council (Various Roads) (Gourock, Inverkip & Wemyss Bay) (Waiting Restrictions)  
(Variation No. 4) Order 2018 On-Street Plans**



**SCHEDULE 2**

**SCHEDULE 3**

**THE INVERCLYDE COUNCIL (VARIOUS ROADS) (GOUROCK, INVERKIP & WEMYSS BAY) (WAITING RESTRICTIONS) ORDER 2013**  
**PLAN INDEX**

Plan Reference	Effective date of original plan	Effective date of Plan Revision										
		1	2	3	4	5	6	7	8	9	10	11
TR/TRO/C133-001	06/10/2014	#####										
TR/TRO/C133-002	06/10/2014											
TR/TRO/C133-003	06/10/2014	#####										
TR/TRO/C133-004	06/10/2014											
TR/TRO/C133-005	06/10/2014	04/04/2016	#####									
TR/TRO/C133-006	06/10/2014	04/04/2016	14/11/2016	#####								
TR/TRO/C133-007	06/10/2014	04/04/2016										
TR/TRO/C133-008	06/10/2014	04/04/2016	#####									
TR/TRO/C133-009	06/10/2014	04/04/2016	#####									
TR/TRO/C133-010	06/10/2014	#####										
TR/TRO/C133-011	06/10/2014											
TR/TRO/C133-012	04/04/2016											
TR/TRO/C133-013	04/04/2016	14/11/2016	#####									
TR/TRO/C133-014	04/04/2016	#####										
TR/TRO/C133-015	04/04/2016											
TR/TRO/C133-016	04/04/2016	#####										
TR/TRO/C133-017	#####											
TR/TRO/C133-018	#####											

DO NOT SCALE

APPENDIX 2

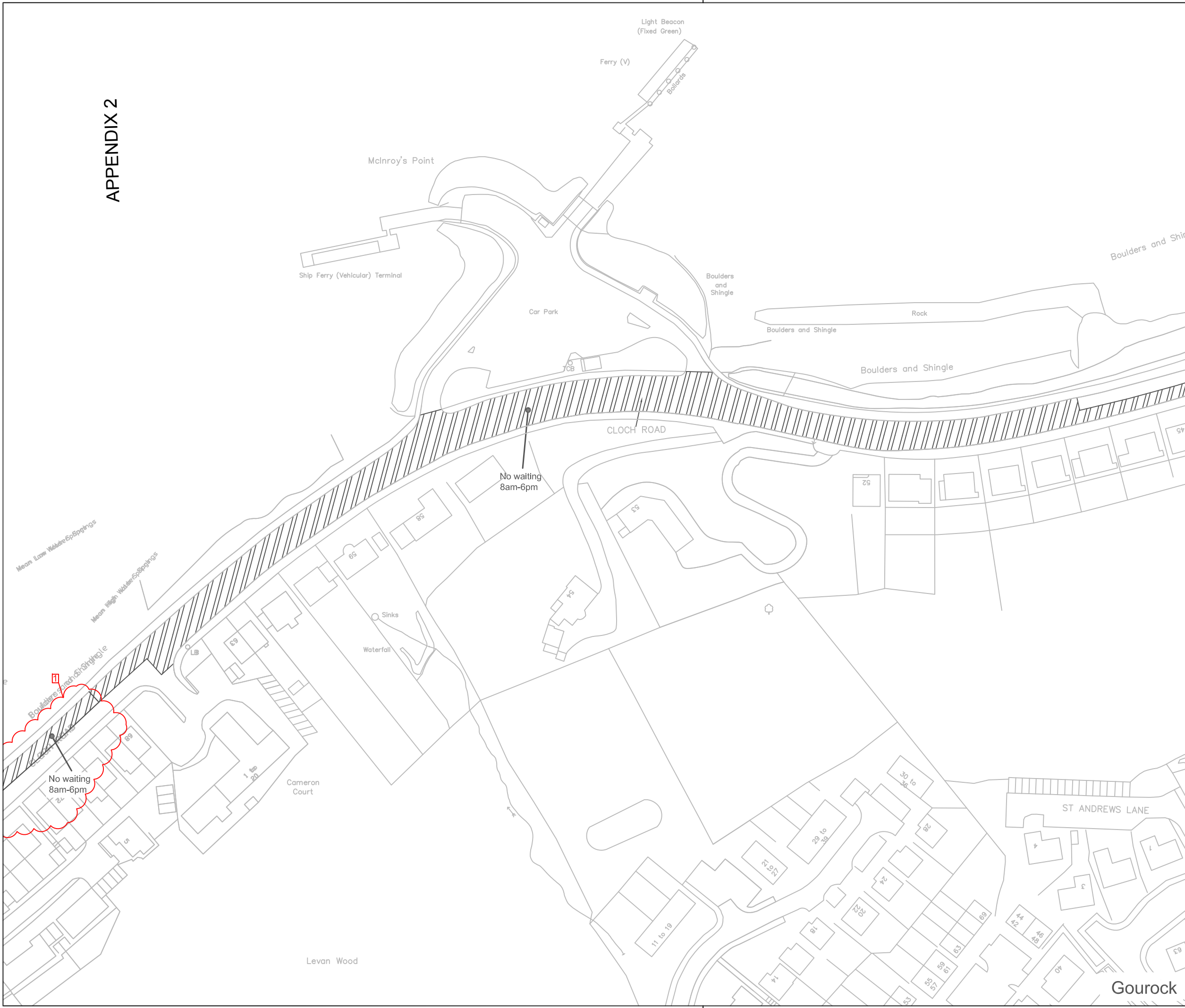

**Key**

	No waiting at any time
	No waiting at any time No loading at any time
	No waiting at times shown
	No waiting at times shown No loading at times shown
	No waiting except taxis
	Limited waiting (see below for types of limited waiting referred to on these drawings)
	Disabled person's parking place (subject to restrictions shown)
	Loading bay
	Loading bay at times shown and Limited waiting (see below for types of limited waiting referred to on these drawings)

**Limited Waiting**  
 Type A: Mon-Fri, 8am-6pm, 30mins, No return within 30mins  
 Type B: Mon-Fri 8am-6pm, Saturday 8am-1pm, 30mins, No return within 1 hour  
 Type C: Mon-Sat 8am-6pm, 30mins, No return within 1 hour  
 Type D: Mon-Sat 8am-6pm, 2 hours, No return within 1 hour  
 Type E: Mon-Sat 8am to 6pm, 30 mins, No return within 30 mins  
 Type F: Mon-Sat 8am to 6pm, 1 hour, No return within 30 mins  
 Type G: Mon-Sat 8am to 6pm, 2 hours, No return within 30 mins  
 Type H: Mon-Fri 8am to 6pm, 2 hours, No return within 30 mins  
 Type J: Mon-Sat 8am to 6pm, 1 hour, No return within 1 hour  
 Type K: Mon-Fri 8am to 6pm, 2 hours, No return within 30 mins except Permit Holders  
 Type L: Mon-Sat 11am to 6pm, 1 hour, No return within 1 hour  
 Type M: Mon-Sat 8am to 6pm, 3 hours, No return within 1 hour  
 Type N: Mon-Fri 8am to 6pm, 30 mins, No return within 30 mins except Permit Holders  
 Type P: Mon-Sun 8am to 10pm, 30 mins, No return within 30 mins except Permit Holders  
 Type Q: Mon-Sun 8am to 10pm, 2 hours, No return within 30 mins

© Crown copyright and database rights 2018 Ordnance Survey 100023421

Seal

Stat	Purpose of Issue	Date	Auth

Rev	Description	By	Date	Chk'd	Auth
1	EXTEND NW 8AM-6PM ON CLOCH RD	EP	JAN '18	EP	GL

**INVERCLYDE COUNCIL**  
 Vehicle Maintenance Facility  
 8 Pottery Street  
 Greenock  
 PA15 2UH  
 Tel: 01475 717171  
 Email: roads@inverclyde.gov.uk  
 www.inverclyde.gov.uk



THE INVERCLYDE COUNCIL (VARIOUS ROADS)  
 (GOUROCK, INVERKIP & WEMYSS BAY)  
 (WAITING RESTRICTIONS) (VARIATION 4)  
 ORDER 2018

EFFECTIVE DATE:

Sheet Size	Original Scale	Designed/Drawn	Checked	Authorised
A3	1:1250	MJH	MJH	MR
Status	Drawing Number	Date	Date	Date
P	TR/TRO/C133-001	FEB '13	FEB '13	FEB '13
Rev				

DO NOT SCALE

A3  
 0 10 50

APPENDIX 3



**Key**

- No waiting at any time
- No waiting at any time  
No loading at any time
- No waiting at times shown
- No waiting at any time  
No loading at times shown
- No waiting except taxis
- Limited waiting  
(see below for types of limited waiting referred to on these drawings)
- Disabled person's parking place  
(subject to restrictions shown)
- Loading bay
- Loading bay at times shown and  
Limited waiting (see below for types of limited waiting referred to on these drawings)

**Limited Waiting**  
 Type A: Mon-Fri, 8am-6pm, 30mins, No return within 30mins  
 Type B: Mon-Fri 8am-6pm, Saturday 8am-1pm, 30mins, No return within 1 hour  
 Type C: Mon-Sat 8am-6pm, 30mins, No return within 1 hour  
 Type D: Mon-Sat 8am-6pm, 2 hours, No return within 1 hour  
 Type E: Mon-Sat 8am to 6pm, 30 mins, No return within 30 mins  
 Type F: Mon-Sat 8am to 6pm, 1 hour, No return within 30 mins  
 Type G: Mon-Sat 8am to 6pm, 2 hours, No return within 30 mins  
 Type H: Mon-Fri 8am to 6pm, 2 hours, No return within 30 mins  
 Type J: Mon-Sat 8am to 6pm, 1 hour, No return within 1 hour  
 Type K: Mon-Fri 8am to 6pm, 2 hours, No return within 30 mins except Permit Holders  
 Type L: Mon-Sat 11am to 6pm, 1 hour, No return within 1 hour  
 Type M: Mon-Sat 8am to 6pm, 3 hours, No return within 1 hour  
 Type N: Mon-Fri 8am to 6pm, 30 mins, No return within 30 mins except Permit Holders  
 Type P: Mon-Sun 8am to 10pm, 30 mins, No return within 30 mins except Permit Holders  
 Type Q: Mon-Sun 8am to 10pm, 2 hours, No return within 30 mins

© Crown copyright and database rights 2018 Ordnance Survey 100023421

Stat

Stat	Purpose of Issue	Date	Auth
1	PART REVOCATION YELLOW LINE VICTORIA RD	EP JAN '18	EP GL

Rev

Rev	Description	By	Date	Chk'd	Auth
1	PART REVOCATION YELLOW LINE VICTORIA RD	EP	JAN '18	EP	GL

**INVERCLYDE COUNCIL**  
 Vehicle Maintenance Facility  
 8 Pottery Street  
 Greenock  
 PA15 2UH  
 Tel: 01475 717171  
 Email: roads@inverclyde.gov.uk  
 www.inverclyde.gov.uk



THE INVERCLYDE COUNCIL (VARIOUS ROADS)  
 (GOUROCK, INVERKIP & WEMYSS BAY)  
 (WAITING RESTRICTIONS) (VARIATION 4)  
 ORDER 2018

EFFECTIVE DATE:

Sheet Size	Original Scale	Designed/Drawn	Checked	Authorised
A3	1:1250	MJH	MJH	MR
Status	Drawing Number	Date	Date	Date
P	TR/TRO/C133-003	FEB '13	FEB '13	FEB '13
Rev				
				1



DO NOT SCALE

APPENDIX 4

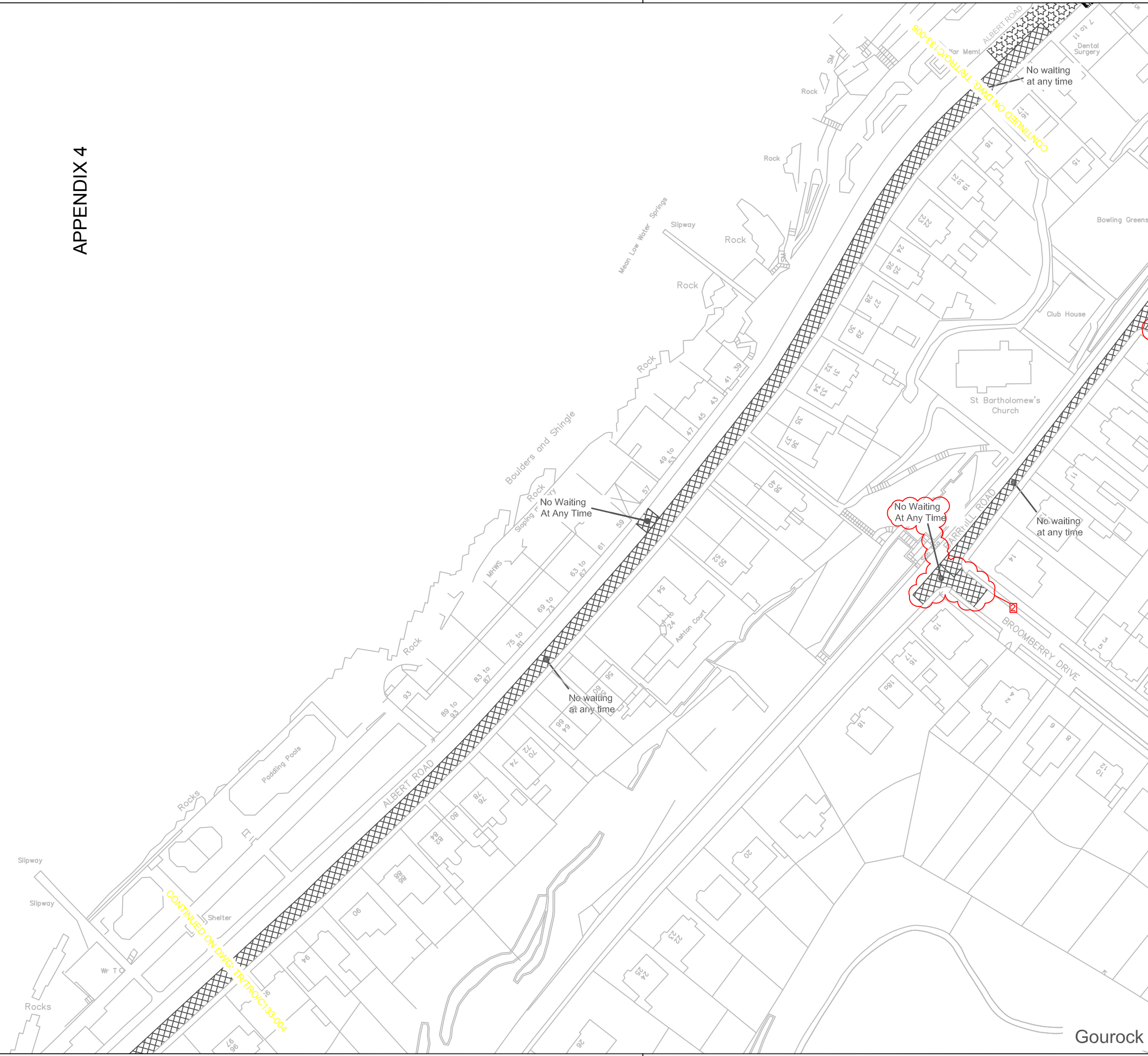

**Key**

	No waiting at any time
	No waiting at any time No loading at any time
	No waiting at times shown
	No waiting at any time No loading at times shown
	No waiting except taxis
	Limited waiting (see below for types of limited waiting referred to on these drawings) Disabled person's parking place (subject to restrictions shown)
	Loading bay
	Loading bay at times shown and Limited waiting (see below for types of limited waiting referred to on these drawings)

**Limited Waiting**  
 Type A: Mon-Fri: 8am-6pm, 30mins, No return within 30mins  
 Type B: Mon-Fri 8am-6pm, Saturday 8am-1pm, 30mins, No return within 1 hour  
 Type C: Mon-Sat 8am-6pm, 30mins, No return within 1 hour  
 Type D: Mon-Sat 8am-6pm, 2 hours, No return within 1 hour  
 Type E: Mon-Sat 8am to 6pm, 30 mins, No return within 30 mins  
 Type F: Mon-Sat 8am to 6pm, 1 hour, No return within 30 mins  
 Type G: Mon-Sat 8am to 6pm, 2 hours, No return within 30 mins  
 Type H: Mon-Fri 8am to 6pm, 2 hours, No return within 30 mins  
 Type J: Mon-Sat 8am to 6pm, 1 hour, No return within 1 hour  
 Type K: Mon-Fri 8am to 6pm, 2 hours, No return within 30 mins except Permit Holders  
 Type L: Mon-Sat 11am to 6pm, 1 hour, No return within 1 hour  
 Type M: Mon-Sat 8am to 6pm, 3 hours, No return within 1 hour  
 Type N: Mon-Fri 8am to 6pm, 30 mins, No return within 30 mins except Permit Holders  
 Type P: Mon-Sun 8am to 10pm, 30 mins, No return within 30 mins except Permit Holders  
 Type Q: Mon-Sun 8am to 10pm, 2 hours, No return within 30 mins

© Crown copyright and database rights 2018 Ordnance Survey 100023421

Seal

Stat	Purpose of Issue	Date	Auth
2	NWAAT ADDED BROOMBERRY DR/BARRHILL RD	EP JAN '18	EP GL
1	NWAAT ADDED OUTSIDE 57-59 ALBERT RD	EP JUN '15	EP MH

**INVERCLYDE COUNCIL**  
 Vehicle Maintenance Facility  
 8 Pottery Street  
 Greenock  
 PA15 2UH  
 Tel: 01475 717171  
 Email: roads@inverclyde.gov.uk  
 www.inverclyde.gov.uk



THE INVERCLYDE COUNCIL (VARIOUS ROADS)  
 (GOUROCK, INVERKIP & WEMYSS BAY)  
 (WAITING RESTRICTIONS) (VARIATION No. 4)  
 ORDER 2018

EFFECTIVE DATE:

Sheet Size	Original Scale	Designed/Drawn	Checked	Authorised
A3	1:1250	MJH	MJH	MR
Status	Drawing Number	Date	Date	Date
P	TR/TRO/C133-005	FEB '13	FEB '13	FEB '13
Rev				



DO NOT SCALE

A3

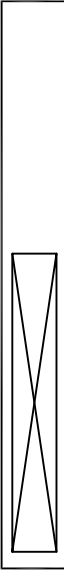

APPENDIX 5

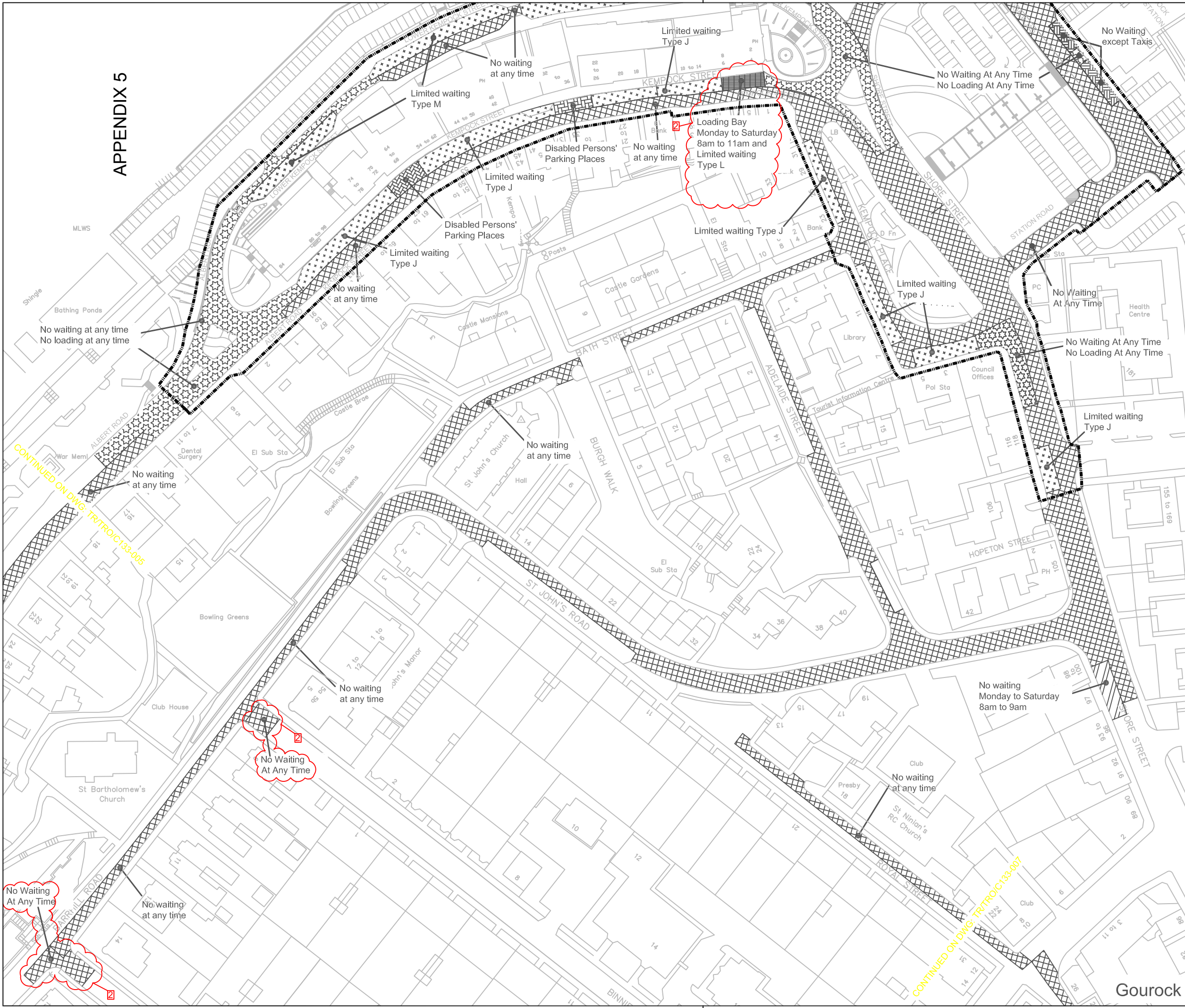

**Key**

- No waiting at any time
- No waiting at any time  
No loading at any time
- No waiting at times shown
- No waiting at any time  
No loading at times shown
- No waiting except taxis
- Limited waiting  
(see below for types of limited waiting referred to on these drawings)
- Disabled person's parking place  
(subject to restrictions shown)
- Loading bay
- Loading bay at times shown and  
Limited waiting (see below for types of limited waiting referred to on these drawings)
- Parking Disc Area

**Limited Waiting**

Type A: Mon-Fri, 8am-6pm, 30mins, No return within 30mins  
 Type B: Mon-Fri 8am-6pm, Saturday 8am-1pm, 30mins, No return within 1 hour  
 Type C: Mon-Sat 8am-6pm, 30mins, No return within 1 hour  
 Type D: Mon-Sat 8am-6pm, 2 hours, No return within 1 hour  
 Type E: Mon-Sat 8am to 6pm, 30 mins, No return within 30 mins  
 Type F: Mon-Sat 8am to 6pm, 1 hour, No return within 30 mins  
 Type G: Mon-Sat 8am to 6pm, 2 hours, No return within 30 mins  
 Type H: Mon-Fri 8am to 6pm, 2 hours, No return within 30 mins  
 Type J: Mon-Sat 8am to 6pm, 1 hour, No return within 1 hour  
 Type K: Mon-Fri 8am to 6pm, 2 hours, No return within 30 mins except Permit Holders  
 Type L: Mon-Sat 11am to 6pm, 1 hour, No return within 1 hour  
 Type M: Mon-Sat 8am to 6pm, 3 hours, No return within 1 hour  
 Type N: Mon-Fri 8am to 6pm, 30 mins, No return within 30 mins except Permit Holders  
 Type P: Mon-Sun 8am to 10pm, 30 mins, No return within 30 mins except Permit Holders  
 Type Q: Mon-Sun 8am to 10pm, 2 hours, No return within 30 mins

© Crown copyright and database rights 2018 Ordnance Survey 100023421

Stat	Purpose of Issue	Date	Auth
3	NWAAT BINNIE /BROOMBERRY /BARRHILL	EP JAN '18	EP GL
3	KEMPOCK ST LOADING BAY & 1 HR PARKING	EP JAN '18	EP GL
2	LOWER KEMPOCK ST INCREASE TO 3 HOURS	EP JUN '16	EP GB
1	VARIOUS CHANGES	EP JUN '15	EP MH

Rev	Description	By	Date	Chk'd	Auth

**INVERCLYDE COUNCIL**  
 Vehicle Maintenance Facility  
 8 Pottery Street  
 Greenock  
 PA15 2UH  
 Tel: 01475 717171  
 Email: roads@inverclyde.gov.uk  
 www.inverclyde.gov.uk



THE INVERCLYDE COUNCIL (VARIOUS ROADS)  
 (GOUROCK, INVERKIP & WEMYSS BAY)  
 (WAITING RESTRICTIONS) (VARIATION No. 4)  
 ORDER 2018

EFFECTIVE DATE:

Sheet Size	Original Scale	Designed/Drawn	Checked	Authorised
A3	1:1250	MJH	MJH	MR
Status	Drawing Number	Date	Date	Date
P	TR/TRO/C133-006	FEB '13	FEB '13	FEB '13
Rev				

CONTINUED ON DWG: TR/TRO/C133-005

CONTINUED ON DWG: TR/TRO/C133-007

Gourock



DO NOT SCALE

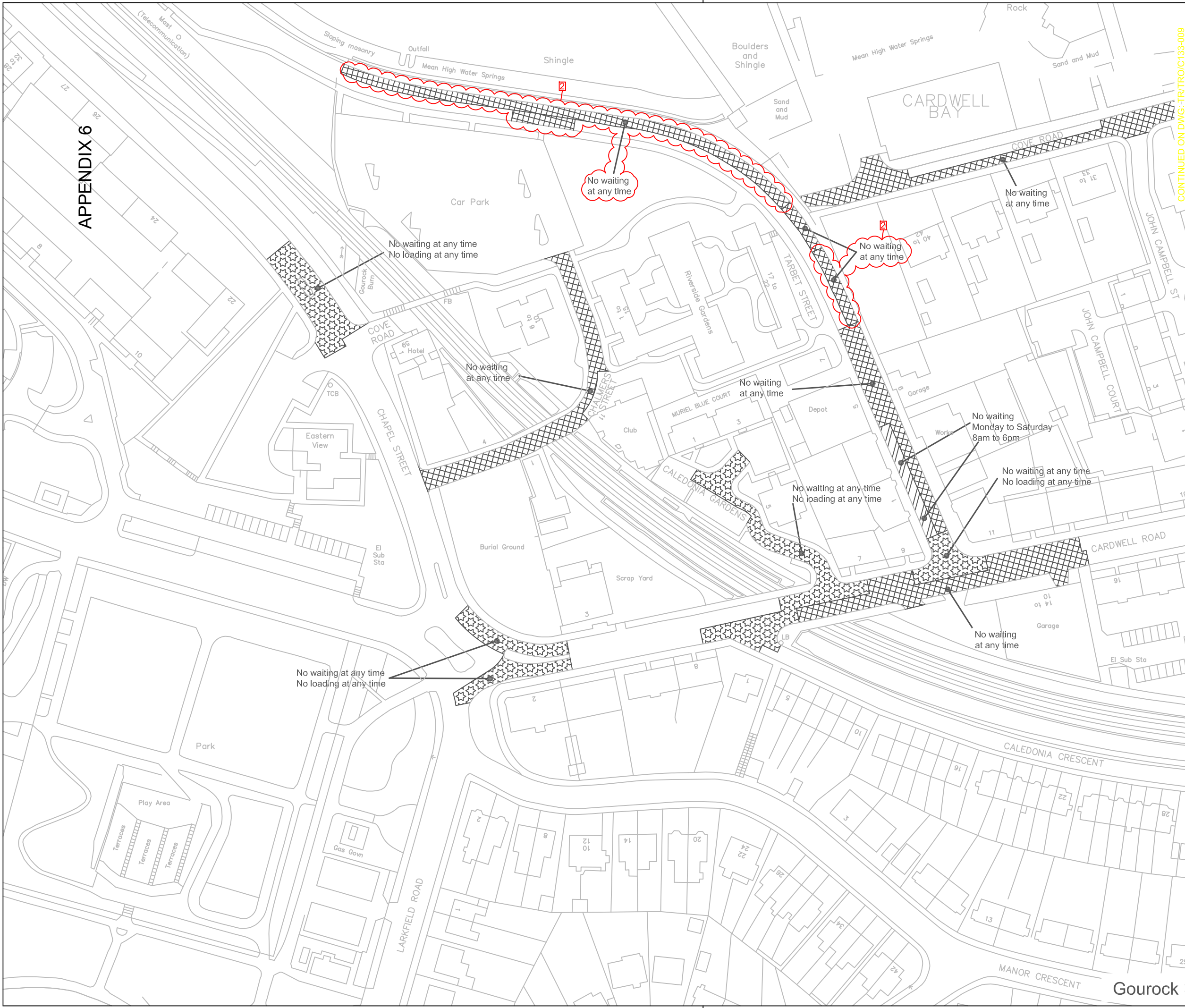

**Key**

- No waiting at any time
- No waiting at any time, No loading at any time
- No waiting at times shown
- No waiting at any time, No loading at times shown
- No waiting except taxis
- Limited waiting (see below for types of limited waiting referred to on these drawings)
- Disabled person's parking place (subject to restrictions shown)
- Loading bay
- Loading bay at times shown and Limited waiting (see below for types of limited waiting referred to on these drawings)

**Limited Waiting**  
 Type A: Mon-Fri 8am-6pm, 30mins, No return within 30mins  
 Type B: Mon-Fri 8am-6pm, Saturday 8am-1pm, 30mins, No return within 1 hour  
 Type C: Mon-Sat 8am-6pm, 30mins, No return within 1 hour  
 Type D: Mon-Sat 8am-6pm, 2 hours, No return within 1 hour  
 Type E: Mon-Sat 8am to 6pm, 30 mins, No return within 30 mins  
 Type F: Mon-Sat 8am to 6pm, 1 hour, No return within 30 mins  
 Type G: Mon-Sat 8am to 6pm, 2 hours, No return within 30 mins  
 Type H: Mon-Fri 8am to 6pm, 2 hours, No return within 30 mins  
 Type J: Mon-Sat 8am to 6pm, 1 hour, No return within 1 hour  
 Type K: Mon-Fri 8am to 6pm, 2 hours, No return within 30 mins except Permit Holders  
 Type L: Mon-Sat 11am to 6pm, 1 hour, No return within 1 hour  
 Type M: Mon-Sat 8am to 6pm, 3 hours, No return within 1 hour  
 Type N: Mon-Fri 8am to 6pm, 30 mins, No return within 30 mins except Permit Holders  
 Type P: Mon-Sun 8am to 10pm, 30 mins, No return within 30 mins except Permit Holders  
 Type Q: Mon-Sun 8am to 10pm, 2 hours, No return within 30 mins

© Crown copyright and database rights 2018 Ordnance Survey 100023421

Stat	Purpose of Issue	Date	Auth
2	NWAAT ADDED TARGET ST	EP JAN '18	EP GL
1	CHANGE NLAAT TO NW SPECIFIED TIMES	EP JUL '15	EP MH

Rev	Description	By	Date	Chk'd	Auth

**INVERCLYDE COUNCIL**  
 Vehicle Maintenance Facility  
 8 Pottery Street  
 Greenock  
 PA15 2UH  
 Tel: 01475 717171  
 Email: roads@inverclyde.gov.uk  
 www.inverclyde.gov.uk



THE INVERCLYDE COUNCIL (VARIOUS ROADS)  
 (GOUROCK, INVERKIP & WEMYSS BAY)  
 (WAITING RESTRICTIONS) (VARIATION No. 4)  
 ORDER 2018

EFFECTIVE DATE:

Sheet Size	Original Scale	Designed/Drawn	Checked	Authorised
A3	1:1250	MJH	MJH	MR
Status	Drawing Number	Date	Date	Date
P	TR/TRO/C133-008	FEB '13	FEB '13	FEB '13
Rev				



DO NOT SCALE

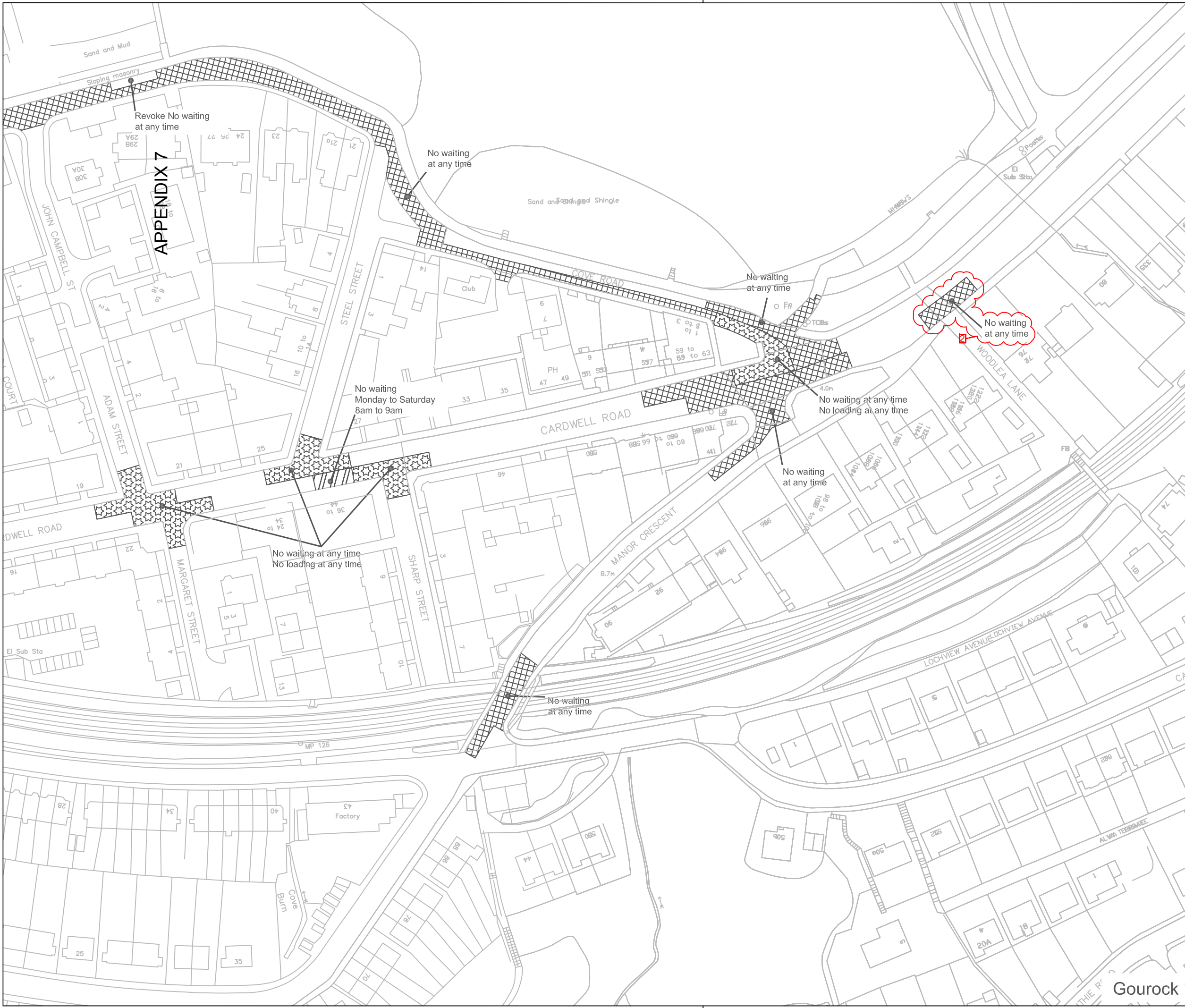
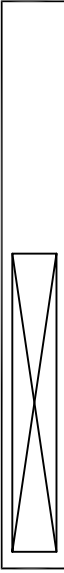

APPENDIX 7

**Key**

[Symbol]	No waiting at any time
[Symbol]	No waiting at any time No loading at any time
[Symbol]	No waiting at times shown No loading at times shown
[Symbol]	No waiting except taxis
[Symbol]	Limited waiting (see below for types of limited waiting referred to on these drawings)
[Symbol]	Disabled person's parking place (subject to restrictions shown)
[Symbol]	Loading bay
[Symbol]	Loading bay at times shown and Limited waiting (see below for types of limited waiting referred to on these drawings)

**Limited Waiting**

Type A:	Mon-Fri 8am-6pm, 30mins, No return within 30mins
Type B:	Mon-Fri 8am-6pm, Saturday 8am-1pm, 30mins, No return within 1 hour
Type C:	Mon-Sat 8am-6pm, 30mins, No return within 1 hour
Type D:	Mon-Sat 8am-6pm, 2 hours, No return within 1 hour
Type E:	Mon-Sat 8am to 6pm, 30 mins, No return within 30 mins
Type F:	Mon-Sat 8am to 6pm, 1 hour, No return within 30 mins
Type G:	Mon-Sat 8am to 6pm, 2 hours, No return within 30 mins
Type H:	Mon-Fri 8am to 6pm, 2 hours, No return within 30 mins
Type J:	Mon-Sat 8am to 6pm, 1 hour, No return within 1 hour
Type K:	Mon-Fri 8am to 6pm, 2 hours, No return within 30 mins except Permit Holders
Type L:	Mon-Sat 11am to 6pm, 1 hour, No return within 1 hour
Type M:	Mon-Sat 8am to 6pm, 3 hours, No return within 1 hour
Type N:	Mon-Fri 8am to 6pm, 30 mins, No return within 30 mins except Permit Holders
Type P:	Mon-Sun 8am to 10pm, 30 mins, No return within 30 mins except Permit Holders
Type Q:	Mon-Sun 8am to 10pm, 2 hours, No return within 30 mins

© Crown copyright and database rights 2018 Ordnance Survey 100023421

**Stat**

Stat	Purpose of Issue	Date	Auth
2	NWAAT ADDED CARDWELL RD AT WOODLEA LN	EP JAN '18	EP GL
1	CHANGES CARDWELL RD & COVE RD	EP JUN '15	EP MH

**Rev**

Rev	Description	By	Date	Chk'd	Auth
2	NWAAT ADDED CARDWELL RD AT WOODLEA LN	EP	JAN '18	EP	GL
1	CHANGES CARDWELL RD & COVE RD	EP	JUN '15	EP	MH

**INVERCLYDE COUNCIL**  
 Vehicle Maintenance Facility  
 8 Pottery Street  
 Greenock  
 PA15 2UH  
 Tel: 01475 717171  
 Email: roads@inverclyde.gov.uk  
 www.inverclyde.gov.uk



THE INVERCLYDE COUNCIL (VARIOUS ROADS)  
 (GOUROCK, INVERKIP & WEMYSS BAY)  
 (WAITING RESTRICTIONS) (VARIATION No. 4)  
 ORDER 2018

EFFECTIVE DATE:

Sheet Size	Original Scale	Designed/Drawn	Checked	Authorised
A3	1:1250	MJH	MJH	MR
Status	Drawing Number	Date	Date	Date
P	TR/TRO/C133-009	FEB '13	FEB '13	FEB '13
Rev				

DO NOT SCALE

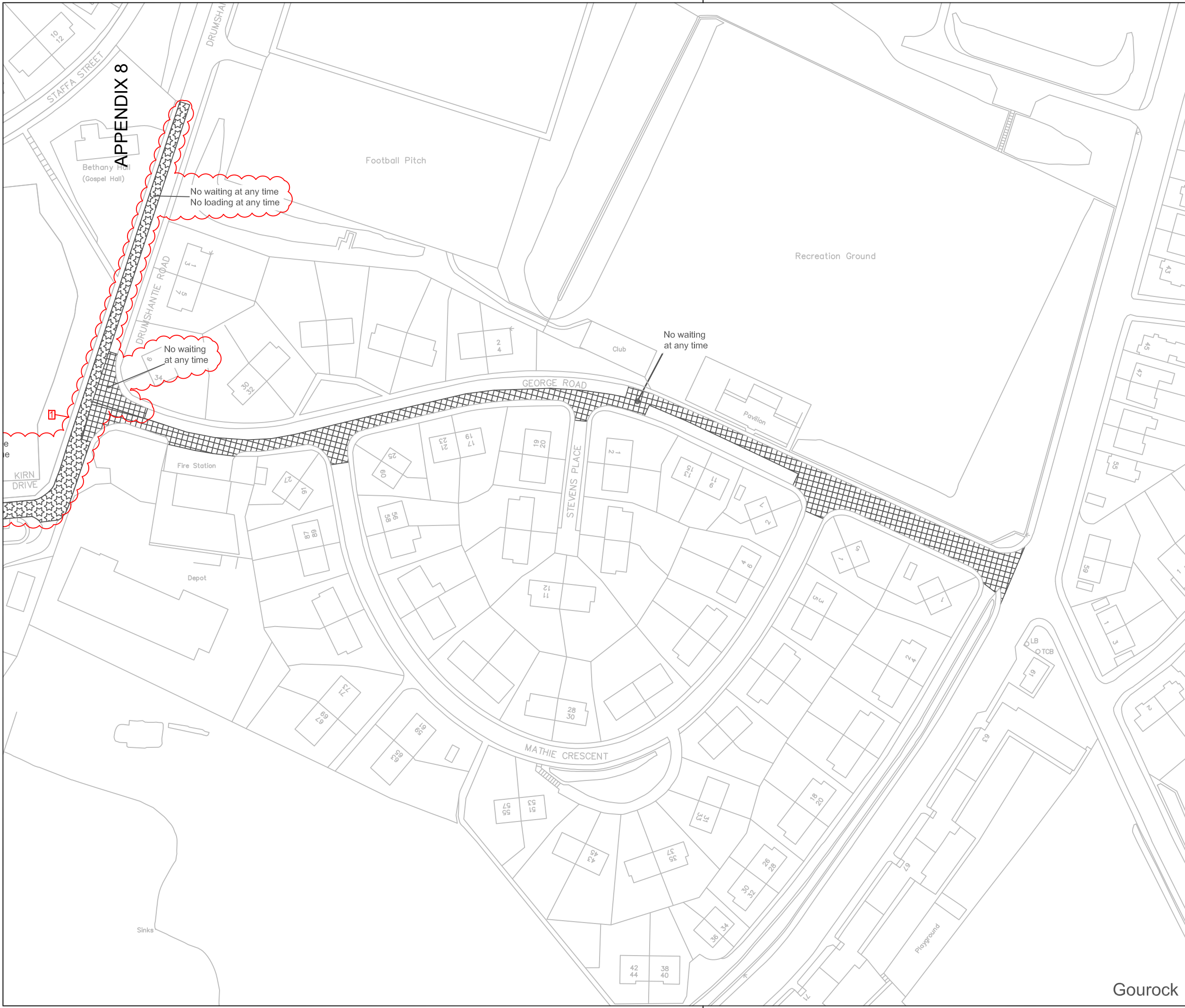

**Key**

- No waiting at any time
- No waiting at any time  
No loading at any time
- No waiting at times shown
- No waiting at times shown  
No loading at times shown
- No waiting except taxis
- Limited waiting  
(see below for types of limited waiting referred to on these drawings)
- Disabled person's parking place  
(subject to restrictions shown)
- Loading bay
- Loading bay at times shown and  
Limited waiting (see below for types of limited waiting referred to on these drawings)

**Limited Waiting**  
 Type A: Mon-Fri, 8am-6pm, 30mins, No return within 30mins  
 Type B: Mon-Fri 8am-6pm, Saturday 8am-1pm, 30mins, No return within 1 hour  
 Type C: Mon-Sat 8am-6pm, 30mins, No return within 1 hour  
 Type D: Mon-Sat 8am-6pm, 2 hours, No return within 1 hour  
 Type E: Mon-Sat 8am to 6pm, 30 mins, No return within 30 mins  
 Type F: Mon-Sat 8am to 6pm, 1 hour, No return within 30 mins  
 Type G: Mon-Sat 8am to 6pm, 2 hours, No return within 30 mins  
 Type H: Mon-Fri 8am to 6pm, 2 hours, No return within 30 mins  
 Type J: Mon-Sat 8am to 6pm, 1 hour, No return within 1 hour  
 Type K: Mon-Fri 8am to 6pm, 2 hours, No return within 30 mins except Permit Holders  
 Type L: Mon-Sat 11am to 6pm, 1 hour, No return within 1 hour  
 Type M: Mon-Sat 8am to 6pm, 3 hours, No return within 1 hour  
 Type N: Mon-Fri 8am to 6pm, 30 mins, No return within 30 mins except Permit Holders  
 Type P: Mon-Sun 8am to 10pm, 30 mins, No return within 30 mins except Permit Holders  
 Type Q: Mon-Sun 8am to 10pm, 2 hours, No return within 30 mins

© Crown copyright and database rights 2018 Ordnance Survey 100023421

Stat

Purpose of Issue	Date	Auth
1 NWAAT/NLAAT DRUMSHANTIE RD/ KIRN DR	EP JAN '18	EP GL
1 NWAAT DRUMSHANTIE RD/ GEORGE RD	EP JAN '18	EP GL

Rev	Description	By	Date	Chk'd	Auth
1	NWAAT/NLAAT DRUMSHANTIE RD/ KIRN DR	EP	JAN '18	EP	GL
1	NWAAT DRUMSHANTIE RD/ GEORGE RD	EP	JAN '18	EP	GL

**INVERCLYDE COUNCIL**  
 Vehicle Maintenance Facility  
 8 Pottery Street  
 Greenock  
 PA15 2UH  
 Tel: 01475 717171  
 Email: roads@inverclyde.gov.uk  
 www.inverclyde.gov.uk



THE INVERCLYDE COUNCIL (VARIOUS ROADS)  
 (GOUROCK, INVERKIP & WEMYSS BAY)  
 (WAITING RESTRICTIONS) (VARIATION 4)  
 ORDER 2018

EFFECTIVE DATE:

Sheet Size	Original Scale	Designed/Drawn	Checked	Authorised
A3	1:1250	MJH	MJH	MR
Status	Drawing Number	Date	Date	Date
P	TR/TRO/C133-010	FEB '13	FEB '13	FEB '13
Rev				
				1

Gourock



DO NOT SCALE

A3

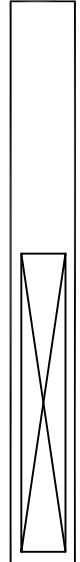

APPENDIX 9

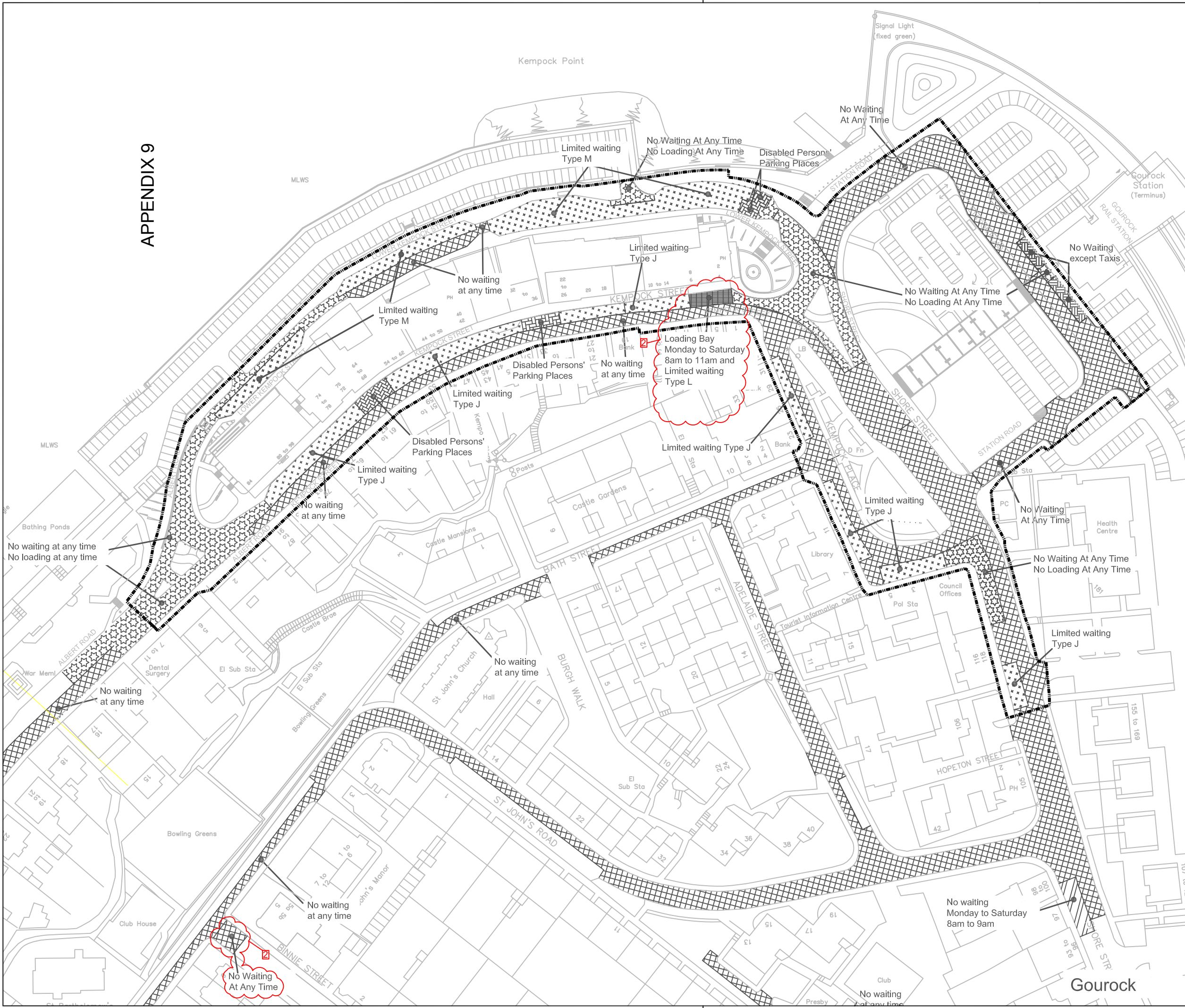

**Key**

- No waiting at any time
- No waiting at any time  
No loading at any time
- No waiting at times shown
- No waiting at any time  
No loading at times shown
- No waiting except taxis
- Limited waiting (see below for types of limited waiting referred to on these drawings)
- Disabled person's parking place (subject to restrictions shown)
- Loading bay
- Loading bay at times shown and Limited waiting (see below for types of limited waiting referred to on these drawings)
- Parking Disc Area

**Limited Waiting**

- Type A: Mon-Fri 8am-6pm, 30mins, No return within 30mins
- Type B: Mon-Fri 8am-6pm, Saturday 8am-1pm, 30mins, No return within 1 hour
- Type C: Mon-Sat 8am-6pm, 30mins, No return within 1 hour
- Type D: Mon-Sat 8am-6pm, 2 hours, No return within 1 hour
- Type E: Mon-Sat 8am to 6pm, 30 mins, No return within 30 mins
- Type F: Mon-Sat 8am to 6pm, 1 hour, No return within 30 mins
- Type G: Mon-Sat 8am to 6pm, 2 hours, No return within 30 mins
- Type H: Mon-Fri 8am to 6pm, 2 hours, No return within 30 mins
- Type J: Mon-Sat 8am to 6pm, 1 hour, No return within 1 hour
- Type K: Mon-Fri 8am to 6pm, 2 hours, No return within 30 mins except Permit Holders
- Type L: Mon-Sat 11am to 6pm, 1 hour, No return within 1 hour
- Type M: Mon-Sat 8am to 6pm, 3 hours, No return within 1 hour
- Type N: Mon-Fri 8am to 6pm, 30 mins, No return within 30 mins except Permit Holders
- Type P: Mon-Sun 8am to 10pm, 30 mins, No return within 30 mins except Permit Holders
- Type Q: Mon-Sun 8am to 10pm, 2 hours, No return within 30 mins

© Crown copyright and database rights 2018 Ordnance Survey 100023421

Stat Purpose of Issue Date Auth

2	NWAAT BINNE ST	EP	JAN '18	EP	GL
2	KEMPOCK ST LOADING BAY & 1 HR PARKING	EP	JAN '18	EP	GL
1	LOWER KEMPOCK ST INCREASE TO 3 HOURS	EP	JUN '16	EP	GB
-	INCLUDE LOWER KEMPOCK ST & STATION RD	EP	JUN '15	EP	MH

Rev Description By Date Chk'd Auth

**INVERCLYDE COUNCIL**  
 Vehicle Maintenance Facility  
 8 Pottery Street  
 Greenock  
 PA15 2UH  
 Tel: 01475 717171  
 Email: roads@inverclyde.gov.uk  
 www.inverclyde.gov.uk



THE INVERCLYDE COUNCIL (VARIOUS ROADS)  
 (GOUROCK, INVERKIP & WEMYSS BAY)  
 (WAITING RESTRICTIONS) (VARIATION No. 4)  
 ORDER 2018

EFFECTIVE DATE:

Sheet Size	Original Scale	Designed/Drawn	Checked	Authorised
A3	1:1250	EP	EP	MH
Status	Drawing Number	Date	Date	Date
P	TR/TRO/C133-013	JUN '15	JUN '15	JUN '15
Rev				Rev
				2



DO NOT SCALE

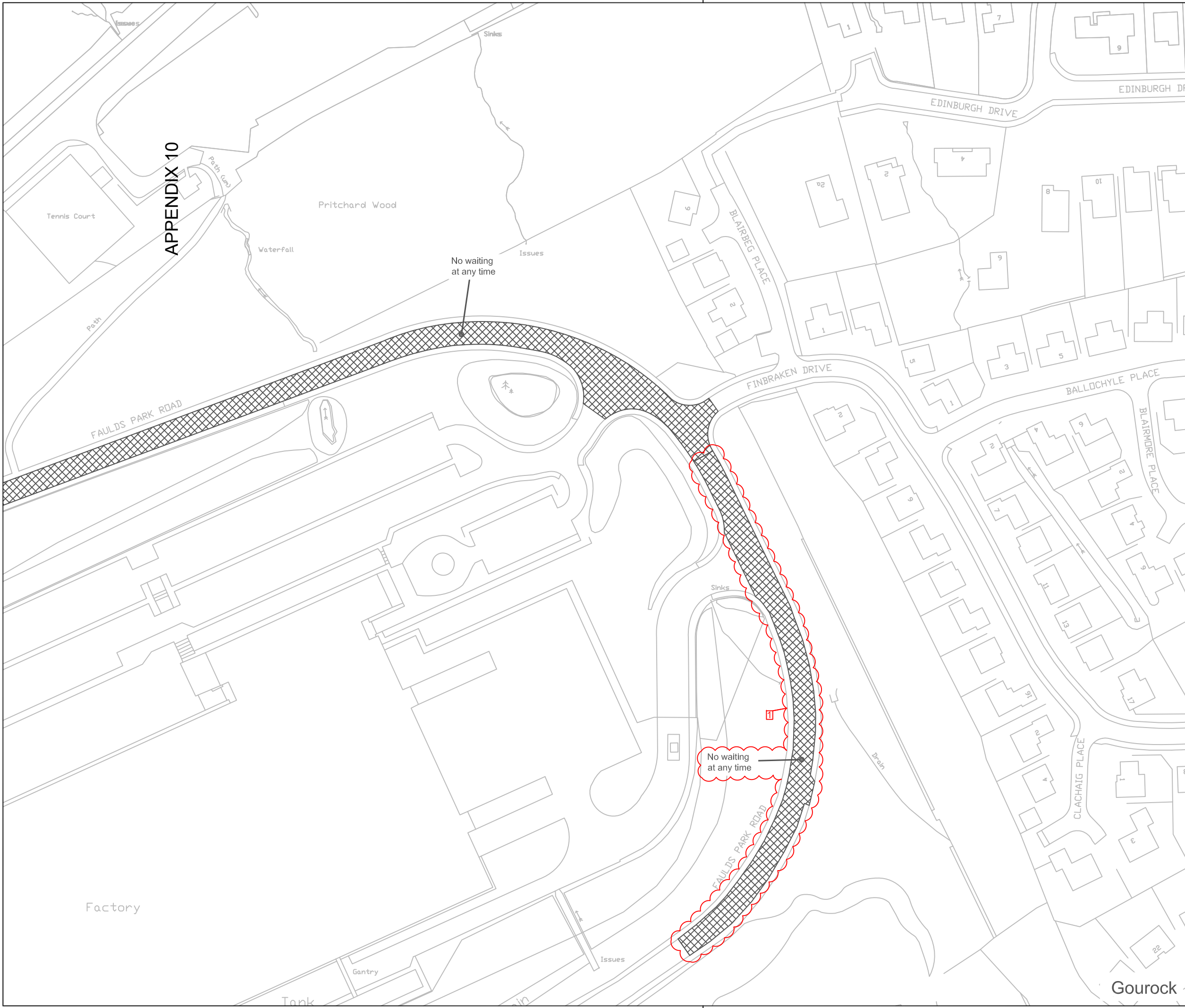
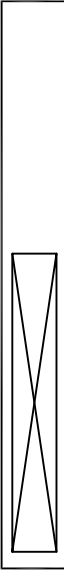

**Key**

	No waiting at any time
	No waiting at any time No loading at any time
	No waiting at times shown No loading at times shown
	No waiting except taxis
	Limited waiting (see below for types of limited waiting referred to on these drawings)
	Disabled person's parking place (subject to restrictions shown)
	Loading bay
	Loading bay at times shown and Limited waiting (see below for types of limited waiting referred to on these drawings)

- Limited Waiting**
- Type A: Mon-Fri, 8am-6pm, 30mins, No return within 30mins
  - Type B: Mon-Fri 8am-6pm, Saturday 8am-1pm, 30mins, No return within 1 hour
  - Type C: Mon-Sat 8am-6pm, 30mins, No return within 1 hour
  - Type D: Mon-Sat 8am-6pm, 2 hours, No return within 1 hour
  - Type E: Mon-Sat 8am to 6pm, 30 mins, No return within 30 mins
  - Type F: Mon-Sat 8am to 6pm, 1 hour, No return within 30 mins
  - Type G: Mon-Sat 8am to 6pm, 2 hours, No return within 30 mins
  - Type H: Mon-Fri 8am to 6pm, 2 hours, No return within 30 mins
  - Type J: Mon-Sat 8am to 6pm, 1 hour, No return within 1 hour
  - Type K: Mon-Fri 8am to 6pm, 2 hours, No return within 30 mins except Permit Holders
  - Type L: Mon-Sat 11am to 6pm, 1 hour, No return within 1 hour
  - Type M: Mon-Sat 8am to 6pm, 3 hours, No return within 1 hour
  - Type N: Mon-Fri 8am to 6pm, 30 mins, No return within 30 mins except Permit Holders
  - Type P: Mon-Sun 8am to 10pm, 30 mins, No return within 30 mins except Permit Holders
  - Type Q: Mon-Sun 8am to 10pm, 2 hours, No return within 30 mins

© Crown copyright and database rights 2018 Ordnance Survey 100023421

Stat

Stat	Purpose of Issue	Date	Auth
1	NWAAT EXTENDED FAULDS PARK ROAD	EP JUN '18	EP GL
-	NWAAT ADDED FAULDS PARK ROAD	EP JUN '15	EP MH

Rev Description By Date Chk'd Auth

**INVERCLYDE COUNCIL**  
 Vehicle Maintenance Facility  
 8 Pottery Street  
 Greenock  
 PA15 2UH  
 Tel: 01475 717171  
 Email: roads@inverclyde.gov.uk  
 www.inverclyde.gov.uk



THE INVERCLYDE COUNCIL (VARIOUS ROADS)  
 (GOUROCK, INVERKIP & WEMYSS BAY)  
 (WAITING RESTRICTIONS) (VARIATION No. 4)  
 ORDER 2018

EFFECTIVE DATE:

Sheet Size	Original Scale	Designed/Drawn	Checked	Authorised
A3	1:1250	EP	EP	MH
Status	Drawing Number	Date	Date	Date
P	TR/TRO/C133-014	JUN '15	JUN '15	JUN '15
Rev				
				1

DO NOT SCALE

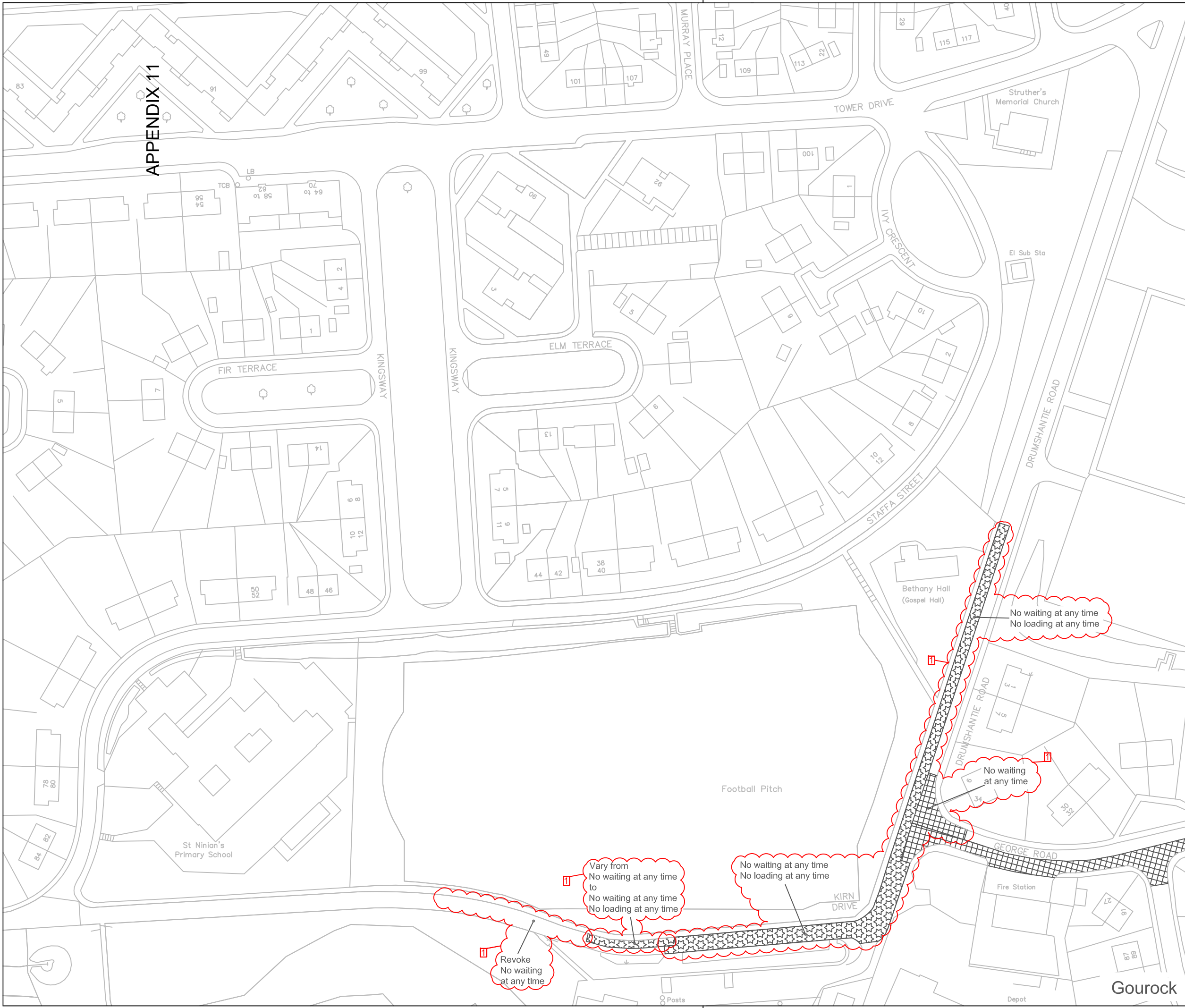
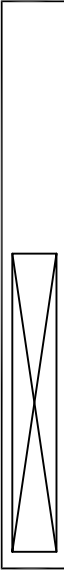

**Key**

- No waiting at any time
- No loading at any time
- No waiting at times shown
- No loading at times shown
- No waiting except taxis
- Limited waiting (see below for types of limited waiting referred to on these drawings)
- Disabled person's parking place (subject to restrictions shown)
- Loading bay
- Loading bay at times shown and Limited waiting (see below for types of limited waiting referred to on these drawings)

**Limited Waiting**  
 Type A: Mon-Fri 8am-6pm, 30mins, No return within 30mins  
 Type B: Mon-Fri 8am-6pm, Saturday 8am-1pm, 30mins, No return within 1 hour  
 Type C: Mon-Sat 8am-6pm, 30mins, No return within 1 hour  
 Type D: Mon-Sat 8am-6pm, 2 hours, No return within 1 hour  
 Type E: Mon-Sat 8am to 6pm, 30 mins, No return within 30 mins  
 Type F: Mon-Sat 8am to 6pm, 1 hour, No return within 30 mins  
 Type G: Mon-Sat 8am to 6pm, 2 hours, No return within 30 mins  
 Type H: Mon-Fri 8am to 6pm, 2 hours, No return within 30 mins  
 Type J: Mon-Sat 8am to 6pm, 1 hour, No return within 1 hour  
 Type K: Mon-Fri 8am to 6pm, 2 hours, No return within 30 mins except Permit Holders  
 Type L: Mon-Sat 11am to 6pm, 1 hour, No return within 1 hour  
 Type M: Mon-Sat 8am to 6pm, 3 hours, No return within 1 hour  
 Type N: Mon-Fri 8am to 6pm, 30 mins, No return within 30 mins except Permit Holders  
 Type P: Mon-Sun 8am to 10pm, 30 mins, No return within 30 mins except Permit Holders  
 Type Q: Mon-Sun 8am to 10pm, 2 hours, No return within 30 mins

© Crown copyright and database rights 2018 Ordnance Survey 100023421

Seal

Stat	Purpose of Issue	Date	Auth
1	NWAAT DRUMSHANTIE RD/ GEORGE RD	EP JAN '18	EP GL
1	NWNLAAT DRUMSHANTIE RD/ KIRN DR	EP JAN '18	EP GL
1	VARY PART NWAAT TO NWNLAAT KIRN DR	EP JAN '18	EP GL
1	REMOVE NWAAT FROM PART OF KIRN DR	EP JAN '18	EP GL

Rev	Description	By	Date	Chk'd	Auth

**INVERCLYDE COUNCIL**  
 Vehicle Maintenance Facility  
 8 Pottery Street  
 Greenock  
 PA15 2UH  
 Tel: 01475 717171  
 Email: roads@inverclyde.gov.uk  
 www.inverclyde.gov.uk



THE INVERCLYDE COUNCIL (VARIOUS ROADS)  
 (GOUROCK, INVERKIP & WEMYSS BAY)  
 (WAITING RESTRICTIONS) (VARIATION No. 4)  
 ORDER 2018

EFFECTIVE DATE:

Sheet Size	Original Scale	Designed/Drawn	Checked	Authorised
A3	1:1250	EP	EP	MH
Status	Drawing Number	Date	Date	Date
P	TR/TRO/C133-016	JUN '15	JUN '15	JUN '15
Rev				



DO NOT SCALE

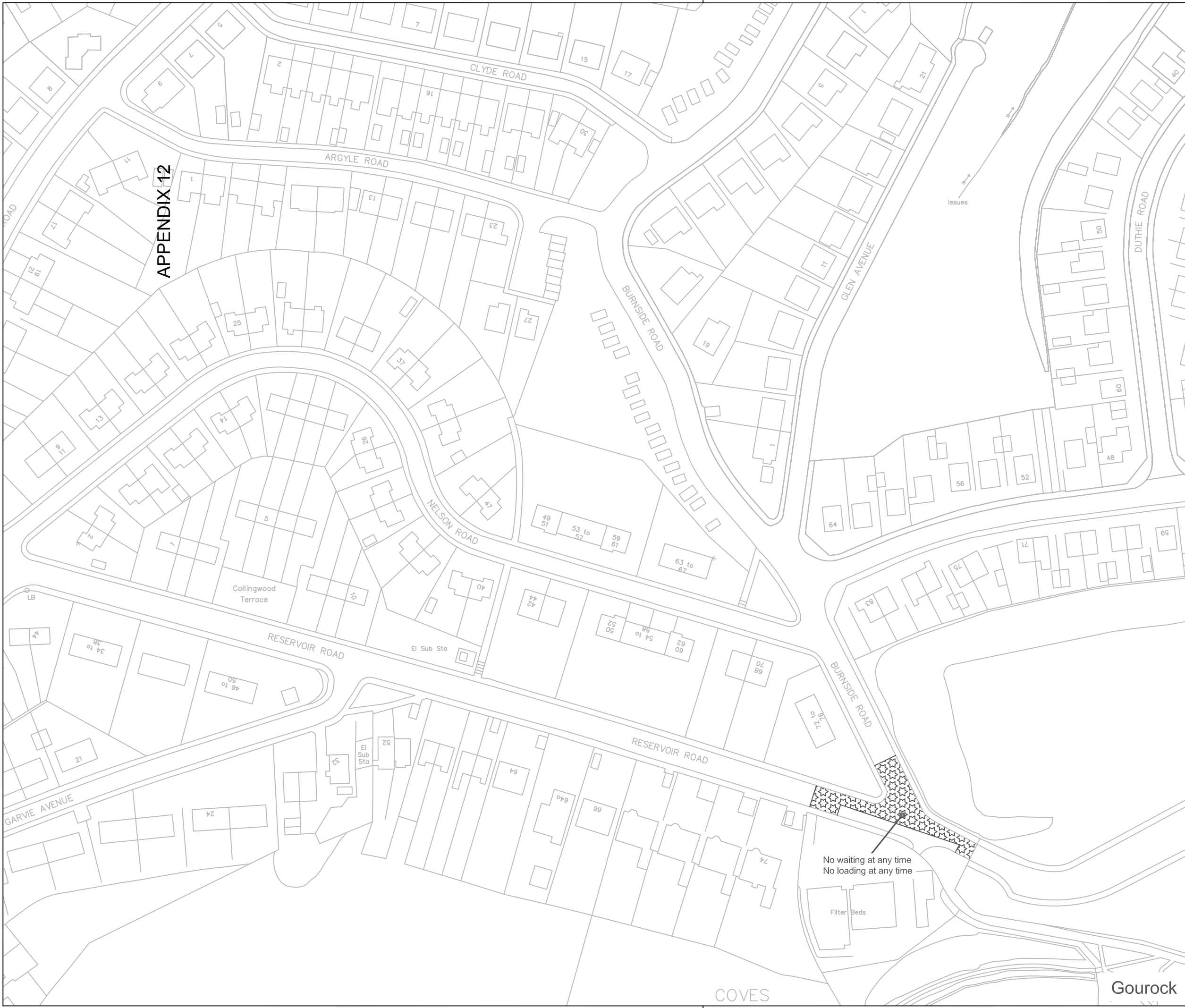

**Key**

- No waiting at any time
- No waiting at any time
- No loading at any time
- No waiting at times shown
- No waiting at any time
- No loading at times shown
- No waiting except taxis
- Limited waiting (see below for types of limited waiting referred to on these drawings)
- Disabled person's parking place (subject to restrictions shown)
- Loading bay
- Loading bay at times shown and Limited waiting (see below for types of limited waiting referred to on these drawings)

**Limited Waiting**

Type A: Mon-Fri, 8am-6pm, 30mins, No return within 30mins  
 Type B: Mon-Fri 8am-6pm, Saturday 8am-1pm, 30mins, No return within 1 hour  
 Type C: Mon-Sat 8am-6pm, 30mins, No return within 1 hour  
 Type D: Mon-Sat 8am-6pm, 2 hours, No return within 1 hour  
 Type E: Mon-Sat 8am to 6pm, 30 mins, No return within 30 mins  
 Type F: Mon-Sat 8am to 6pm, 1 hour, No return within 30 mins  
 Type G: Mon-Sat 8am to 6pm, 2 hours, No return within 30 mins  
 Type H: Mon-Fri 8am to 6pm, 2 hours, No return within 30 mins  
 Type J: Mon-Sat 8am to 6pm, 1 hour, No return within 1 hour  
 Type K: Mon-Fri 8am to 6pm, 2 hours, No return within 30 mins except Permit Holders  
 Type L: Mon-Sat 11am to 6pm, 1 hour, No return within 1 hour  
 Type M: Mon-Sat 8am to 6pm, 3 hours, No return within 1 hour  
 Type N: Mon-Fri 8am to 6pm, 30 mins, No return within 30 mins except Permit Holders  
 Type P: Mon-Sun 8am to 10pm, 30 mins, No return within 30 mins except Permit Holders  
 Type Q: Mon-Sun 8am to 10pm, 2 hours, No return within 30 mins

© Crown copyright and database rights 2018 Ordnance Survey 100023421

Seal

Stat	Purpose of Issue	Date	Auth

Rev	Description	By	Date	Chk'd	Auth
-	NWNLAAT RESERVOIR RD/ BURNSIDE RD	EP	JAN '18	EP	GL

**INVERCLYDE COUNCIL**  
 Vehicle Maintenance Facility  
 8 Pottery Street  
 Greenock  
 PA15 2UH  
 Tel: 01475 717171  
 Email: roads@inverclyde.gov.uk  
 www.inverclyde.gov.uk



THE INVERCLYDE COUNCIL (VARIOUS ROADS)  
 (GOUROCK, INVERKIP & WEMYSS BAY)  
 (WAITING RESTRICTIONS) (VARIATION No. 4)  
 ORDER 2018

EFFECTIVE DATE:

Sheet Size	Original Scale	Designed/Drawn	Checked	Authorised
A3	1:1250	EP	EP	GL
Status	Drawing Number	Date	Date	Date
P	TR/TRO/C133-017	JAN '18	JAN '18	JAN '18
Rev				
-				

APPENDIX 13

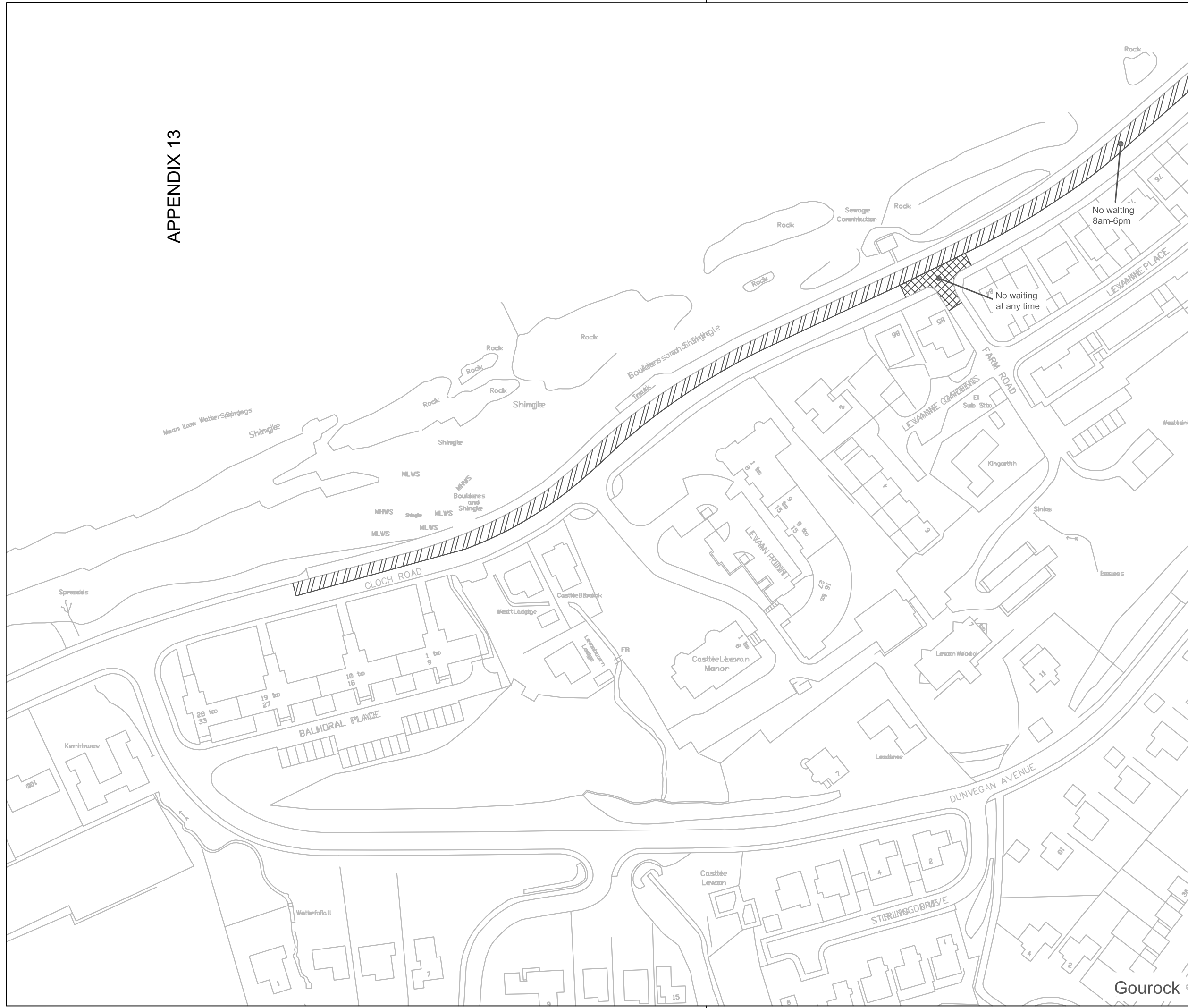

**Key**

- No waiting at any time
- No waiting at any time  
No loading at any time
- No waiting at times shown
- No waiting at any time  
No loading at times shown
- No waiting except taxis
- Limited waiting  
(see below for types of limited waiting referred to on these drawings)
- Disabled person's parking place  
(subject to restrictions shown)
- Loading bay
- Loading bay at times shown and  
Limited waiting (see below for types of limited waiting referred to on these drawings)

**Limited Waiting**  
 Type A: Mon-Fri, 8am-6pm, 30mins, No return within 30mins  
 Type B: Mon-Fri 8am-6pm, Saturday 8am-1pm, 30mins, No return within 1 hour  
 Type C: Mon-Sat 8am-6pm, 30mins, No return within 1 hour  
 Type D: Mon-Sat 8am-6pm, 2 hours, No return within 1 hour  
 Type E: Mon-Sat 8am to 6pm, 30 mins, No return within 30 mins  
 Type F: Mon-Sat 8am to 6pm, 1 hour, No return within 30 mins  
 Type G: Mon-Sat 8am to 6pm, 2 hours, No return within 30 mins  
 Type H: Mon-Fri 8am to 6pm, 2 hours, No return within 30 mins  
 Type J: Mon-Sat 8am to 6pm, 1 hour, No return within 1 hour  
 Type K: Mon-Fri 8am to 6pm, 2 hours, No return within 30 mins except Permit Holders  
 Type L: Mon-Sat 11am to 6pm, 1 hour, No return within 1 hour  
 Type M: Mon-Sat 8am to 6pm, 3 hours, No return within 1 hour  
 Type N: Mon-Fri 8am to 6pm, 30 mins, No return within 30 mins except Permit Holders  
 Type P: Mon-Sun 8am to 10pm, 30 mins, No return within 30 mins except Permit Holders  
 Type Q: Mon-Sun 8am to 10pm, 2 hours, No return within 30 mins

© Crown copyright and database rights 2018 Ordnance Survey 100023421

Stat	Purpose of Issue	Date	Auth
-	NO WAITING 8AM-6PM CLOCH RD	EP JAN '18	EP GL
-	NWAAT CLOCH RD/ FARM RD	EP JAN '18	EP GL

Rev	Description	By	Date	Chk'd	Auth
-	NO WAITING 8AM-6PM CLOCH RD	EP	JAN '18	EP	GL
-	NWAAT CLOCH RD/ FARM RD	EP	JAN '18	EP	GL

**INVERCLYDE COUNCIL**  
 Vehicle Maintenance Facility  
 8 Pottery Street  
 Greenock  
 PA15 2UH  
 Tel: 01475 717171  
 Email: roads@inverclyde.gov.uk  
 www.inverclyde.gov.uk



THE INVERCLYDE COUNCIL (VARIOUS ROADS)  
 (GOUROCK, INVERKIP & WEMYSS BAY)  
 (WAITING RESTRICTIONS) (VARIATION No. 4)  
 ORDER 2018

EFFECTIVE DATE:

Sheet Size	Original Scale	Designed/Drawn	Checked	Authorised
A3	1:1250	EP	EP	GL
Status	Drawing Number	Date	Date	Date
P	TR/TRO/C133-018	JAN '18	JAN '18	JAN '18
Rev				
-				